

IBS48P

KEY FEATURES

10 years
Product
Warranty

25 years
Performance
Warranty



Cell efficiency
up to **19.5 %**



Module efficiency
up to **17.5 %**



Heavy snow load
up to **5,400 Pa**



Wind load
up to **2,400 Pa**



PID Free



ELECTRICAL PARAMETERS

Model	IBS48P		
	205	210	215
Maximum Power (Pmax/W)	205	210	215
Operating Voltage (Vmpp/V)	25.3	25.6	25.9
Operating Current (Impp/A)	8.10	8.20	8.30
Open-Circuit Voltage (Voc/V)	30.2	30.4	30.6
Short-Circuit Current (Isc/A)	8.65	8.72	8.78
Module Efficiency η_m (%)	15.5	15.9	16.3
Power Tolerance	0+5 Wp		
NOCT	47±2°C		

Values at Standard Test Conditions STC (AM 1.5, Irradiance 1000 W/m², Cell Temperature 25°C)

SPECIFICATIONS

Cell Type	Poly Crystalline
Cells size	156x156 mm
Number of cells	48
Weight	14.0 kg
Front side glass	3,2 mm hardened solar tempered glass
Dimensions	1,329x992x35 mm
Cable length	1,000 mm available
Cable cross section size	4 mm ²
Number of bypass diodes	3
Connectors	MC4 compatible
Frame	Anodized Aluminium Alloy
Junction Box	IP65

ENGINEERING DRAWINGS

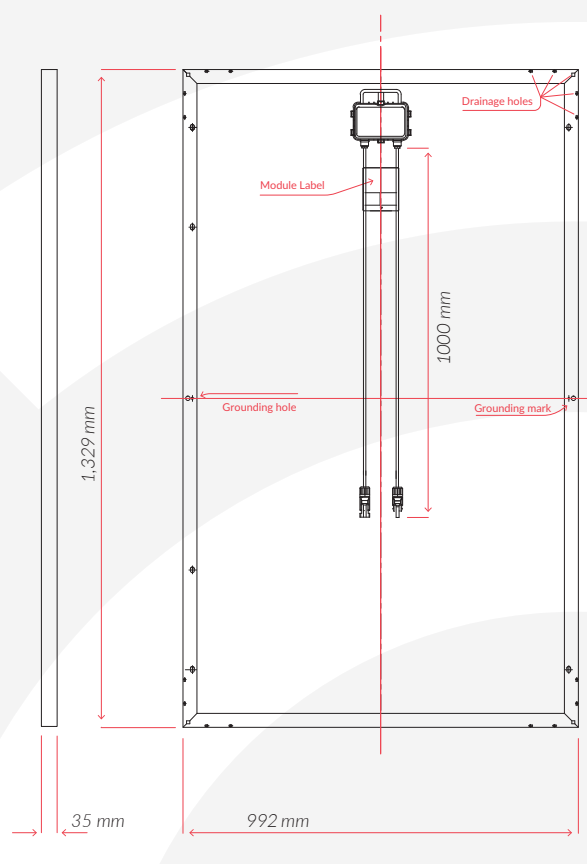

WORKING CONDITIONS

Maximum System Voltage	DC 1,000 V (IEC)
Operating temperature	-40°C / +85° C
Maximum reverse current	15A
IP protection level	IP65
Safety class	II

TEMPERATURE COEFFICIENTS

Power temperature coefficient (Pmax)	-0,41 %/°C
Voltage temperature coefficient (Voc)	-0,33 %/°C
Current temperature coefficient (Isc)	+0,058 %/°C



PACKAGING INFORMATION (I)

Pallet dimension	1,350/1,085/1,140 mm
Pallet weight	459 kg
Modules/pallet	31

PACKAGING INFORMATION (II)

Container	20 GP	40 HQ
Pallets per container	16	33
Pieces per container	496	1040

PARTNERS